



Maintenance tips:

3M™ Speedglas™ Welding Helmet G5-02

To optimize the effective lifetime of your welding equipment and avoid the additional cost of full replacement, regular maintenance is important. Replace all damaged parts immediately to ensure correct levels of protection, see parts list below of spare parts and accessories for this specific helmet. Here are some maintenance tips to keep you going; **always read and follow all User Instructions.**

Before use

- Helmet and headband.** Inspect for cracks or any damaged or defective parts. Replace if needed.
- Welding filter.** Ensure that your welding filter is equipped with an outer and inner protection plate and check that the sensors are clean. Replace the battery if the low battery indicator flashes or if the indicators do not flash when the buttons are pressed.
- Protection plates.** To provide the best possible vision they should be clean and without scratches. Use a moist tissue or cloth, like the cleaning wipe that comes with the helmet.
- Magnification.** If needed try one of our magnifying lenses, available in x1.5, x2.0, x2.5 strengths. The lens is to be attached to the inner protection plate and can be adjusted up/down depending on your work position.

After use

- Clean the helmet.** Wipe with a moist tissue or cloth, both inside and outside the helmet. **DO NOT** rinse, immerse in water or clean with solvents.
- Sweatband.** Remove for additional cleaning as needed and replace whenever it become worn or unhygienic.
- Welding filter.** Clean the welding filter and protection plates with a lint-free tissue or cloth. As the protection plates becomes deeply pitted, scratched or too dirty to clean with soft cloth, it's time to replace them.
- Storage.** Store the helmet in a dry, clean area away from direct sunlight, high temperatures and solvents. Ideally use the bag that comes with the helmet.



Spare parts and consumables

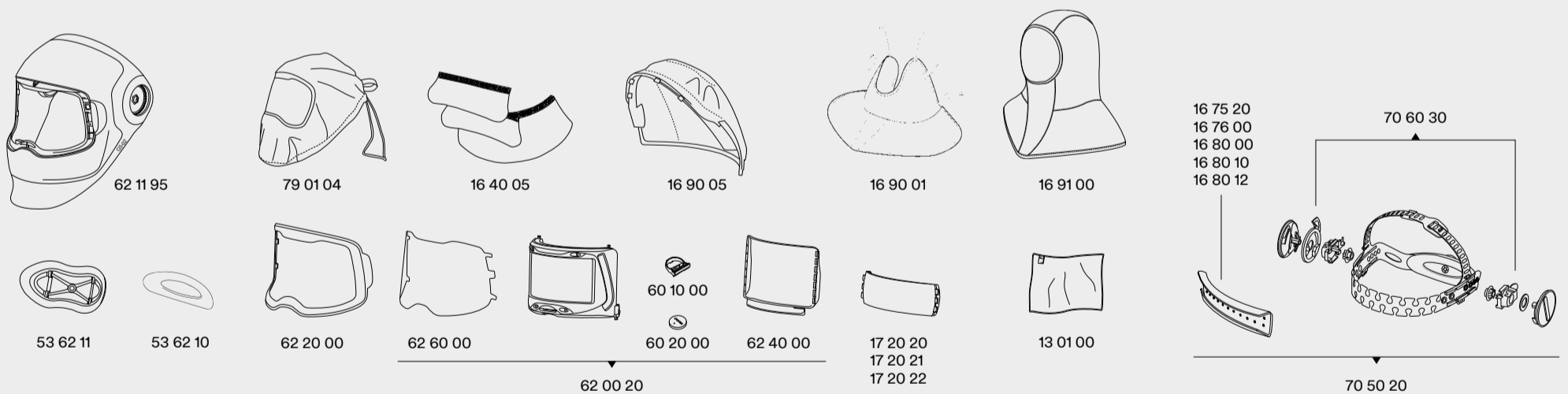

Part No	Description	Part No	Description	Part No	Description
13 01 00	3M cleaning wipe.	16 91 00	Hood black/grey.	62 11 20	Helmet G5-02 with welding filter, headband, cleaning wipe and bag.
16 40 05	Ear and neck protection in leather (3 parts).	17 20 20	Magnifying lens x1.5	62 11 95	Helmet without welding filter, without headband, without front cover.
16 90 05	Head protection in fabric.	17 20 21	Magnifying lens x2.0	62 20 00	Front cover.
16 75 20	Sweatband, towelling, purple, pkg of 2.	17 20 22	Magnifying lens x2.5	62 40 00	Inner protection plates, pkg of 2.
16 76 00	Sweatband, towelling, pkg of 20.	53 62 10	Cushion part for headband	62 60 00	Scratch resistant outer protection plate, pkg of 5.
16 80 00	Sweatband, leather.	53 62 11	Large head rest	70 50 20	Headband with assembly parts and sweatband.
16 80 10	Sweatband in fleecy cotton (length 24 cm), pkg of 2.	60 10 00	Battery holder.	70 60 30	Assembly parts (pivots) for headband.
16 80 12	Sweatband in fleecy cotton (length 21 cm), pkg of 2.	60 20 00	Battery CR2450 Lithium 3V.	79 01 04	Helmet storage bag.
16 90 01	Neck protection.	62 00 20	Curved welding filter G5-02, incl inner and outer protection plates.		

